

FACADE PIVOTANTE

GAMME ACIER NOTICE DE MONTAGE

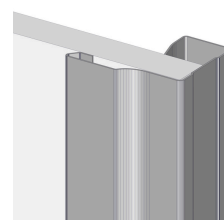

Agate

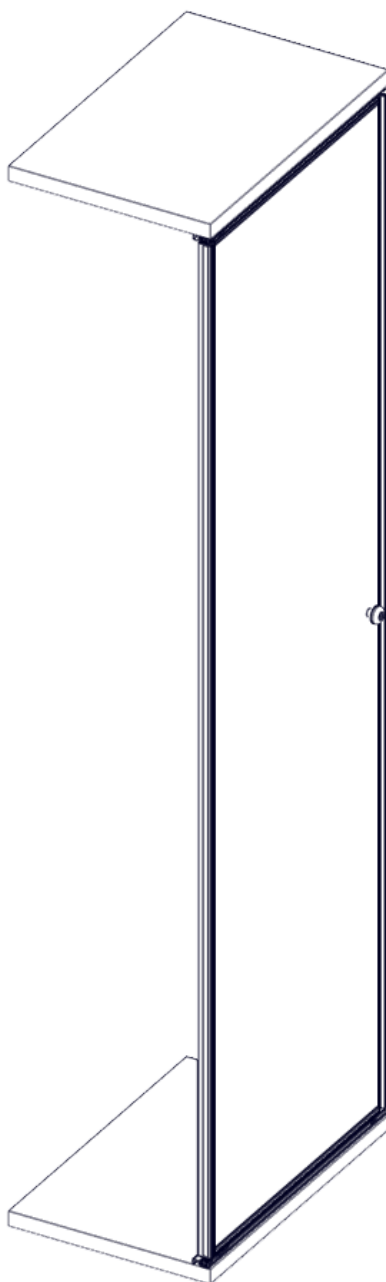
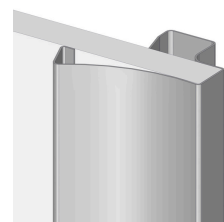

Strass

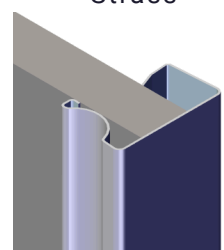

Opale



INFORMATIONS

Conseils d'entretien

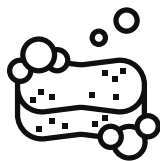

Nettoyer au
savon



Rincer à
l'eau claire



Si besoin,
utiliser du
produit
nettoyant pour
vitres



Sécher avec
un chiffon
propre



**Ne pas
utiliser de
produits
abrasifs**

CITEO | N° REGISTRE FR019580_03UNYT



N° REGISTRE FR019580_103YUI

ecomaison

N° REGISTRE FR019580_04FIWL



FR
Donnez ou recyclez
vos meubles.



Association



Magasin



Déchèterie

<https://quefairedelesdechets.fr>



LE TRI
+ FACILE



ecomaison



Membre de
**l'Ameublement
français**

Fixations



**Aucune visserie n'est
fournie pour la fixation au
mur, au sol, ou au plafond.**
Le choix de la fixation (vis +
cheville) devra être adapté
à votre support.

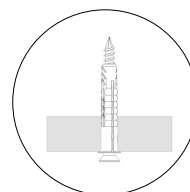
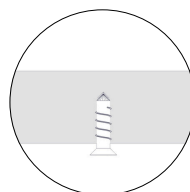
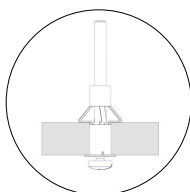

INFORMATIONS

Outils nécessaires

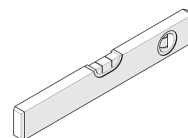
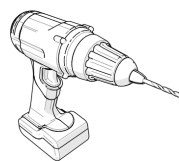
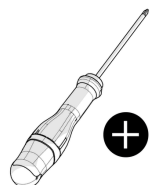
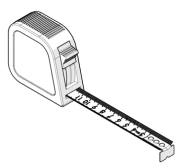

Quincaillerie



Clé allen

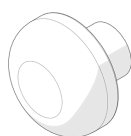

Bouton *
plastique blanc



Vis 5x30 *

*Fournis par
défaut

1 Positionnement des crapaudines et aimants

1.1 Cas d'un tirant gauche / Tirant droit : loqueteau et crapaudine inversés.

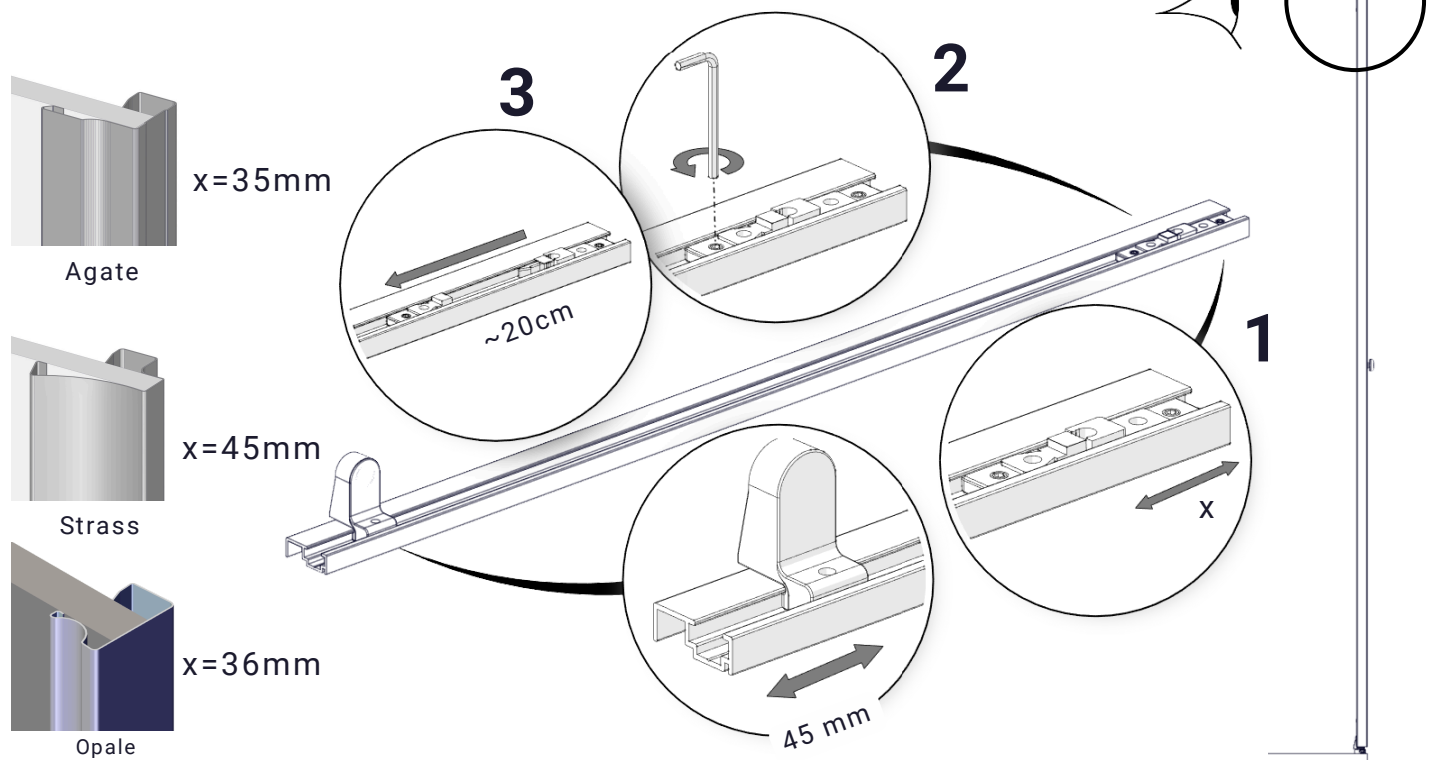

1.2 Cas d'un tirant gauche / Tirant droit : loqueteau et crapaudine inversés.

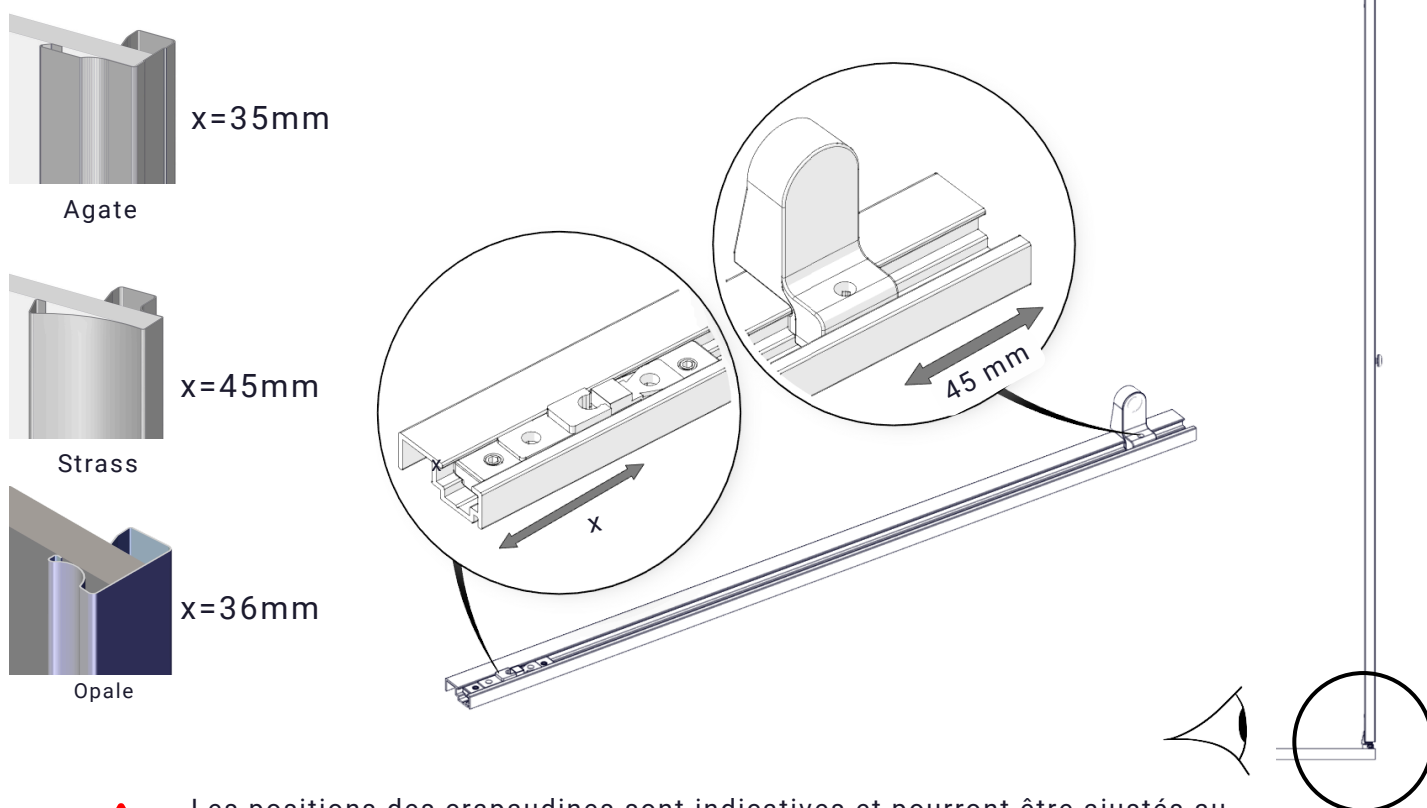

Les positions des crapaudines sont indicatives et pourront être ajustés au montage.

2 Fixation des rails

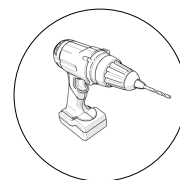

2.1

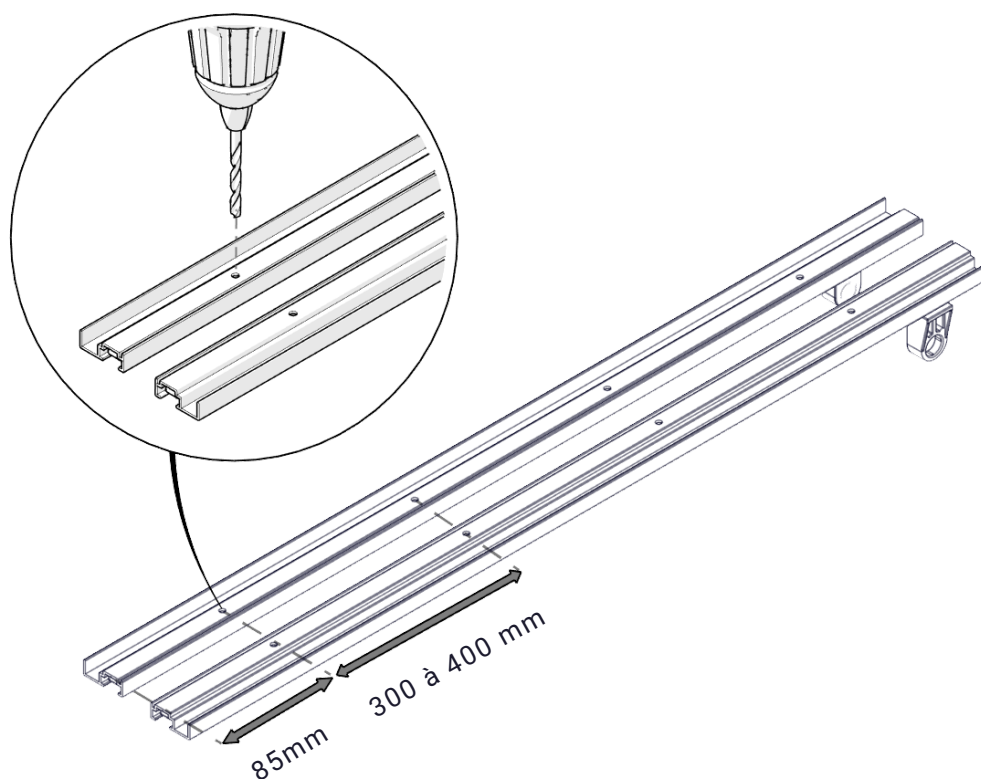

2.2 Visserie non fournie.

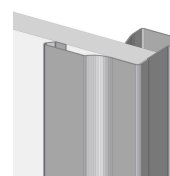
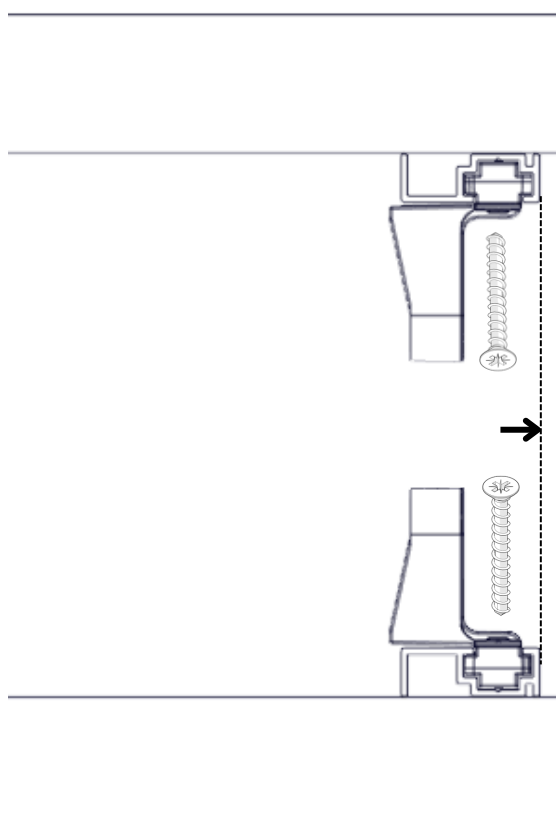

x=1mm

Agate

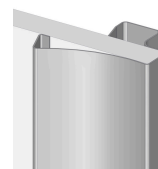

x=7mm

strass

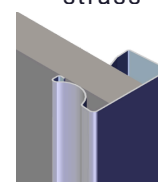

x=4mm

Opale

3 Pose du vantail

3.1

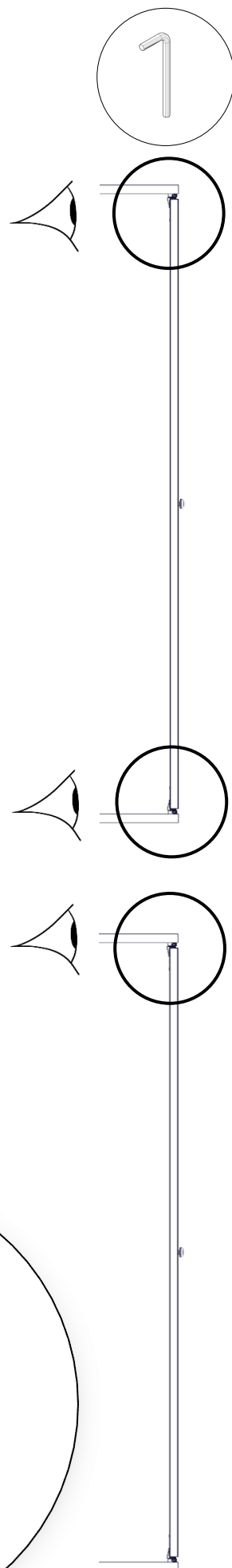
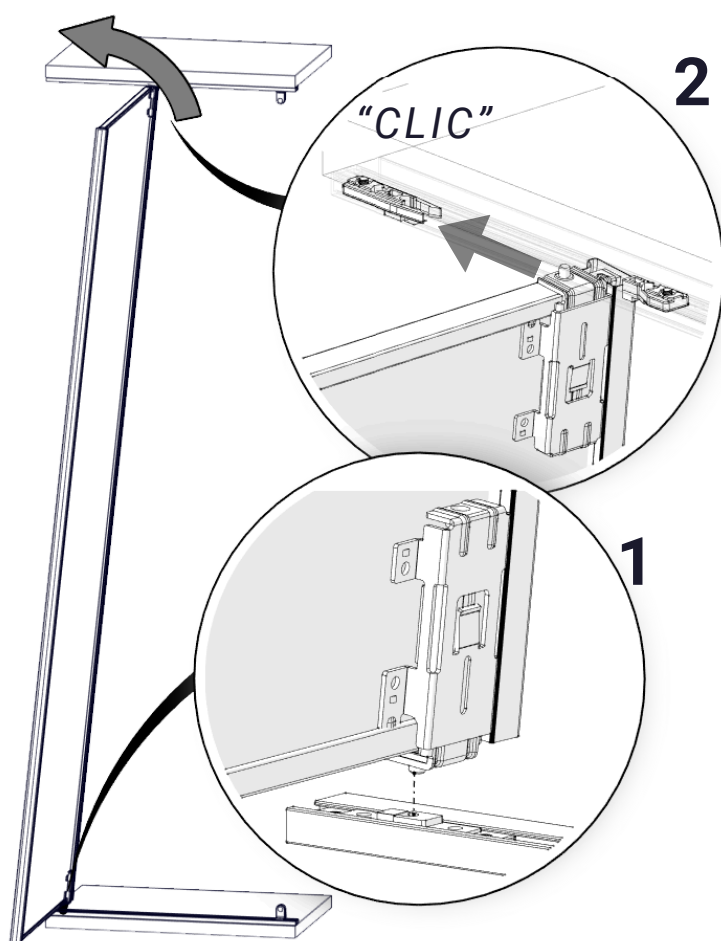

3.2

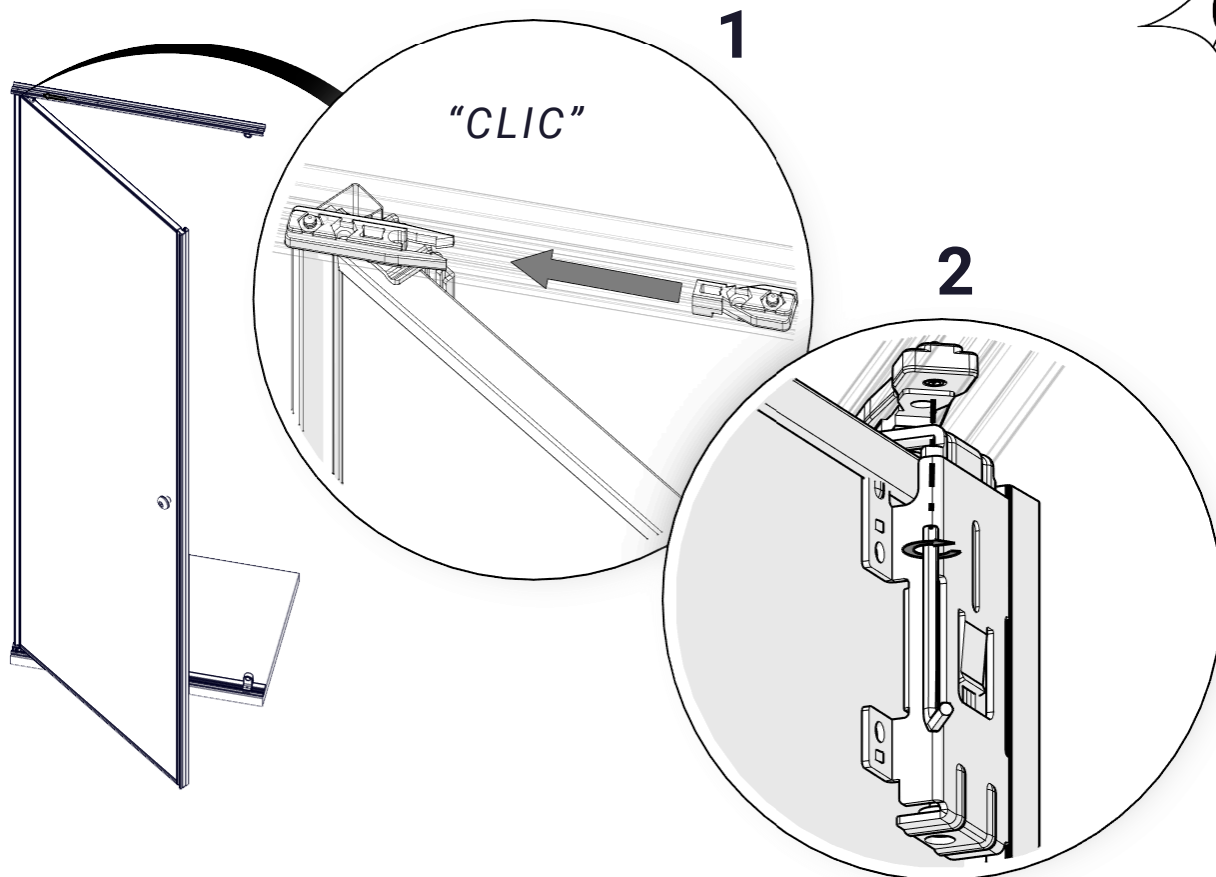

3.3

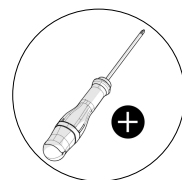
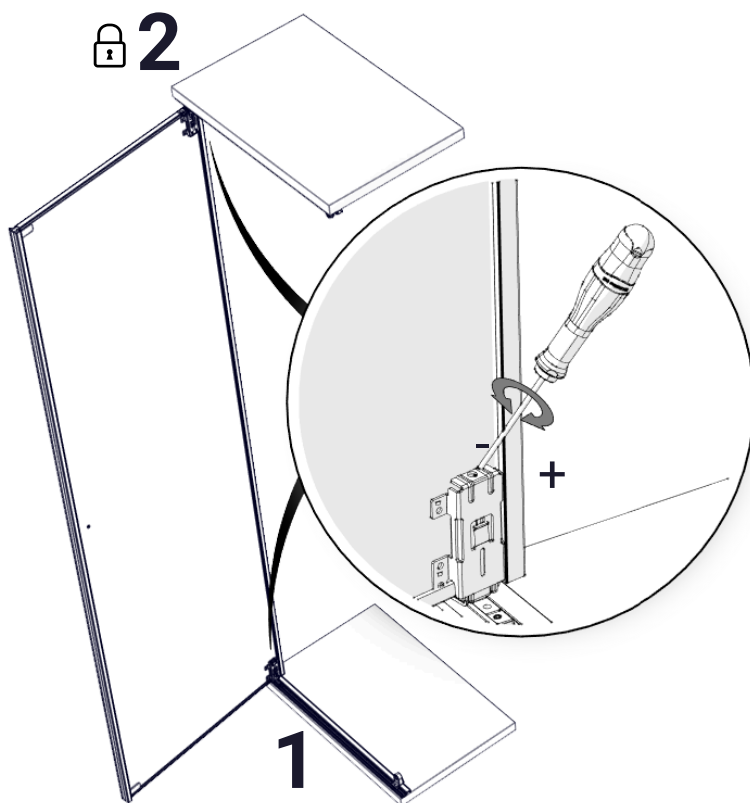

4 Poser le bouton



Si miroir, poignée à coller.

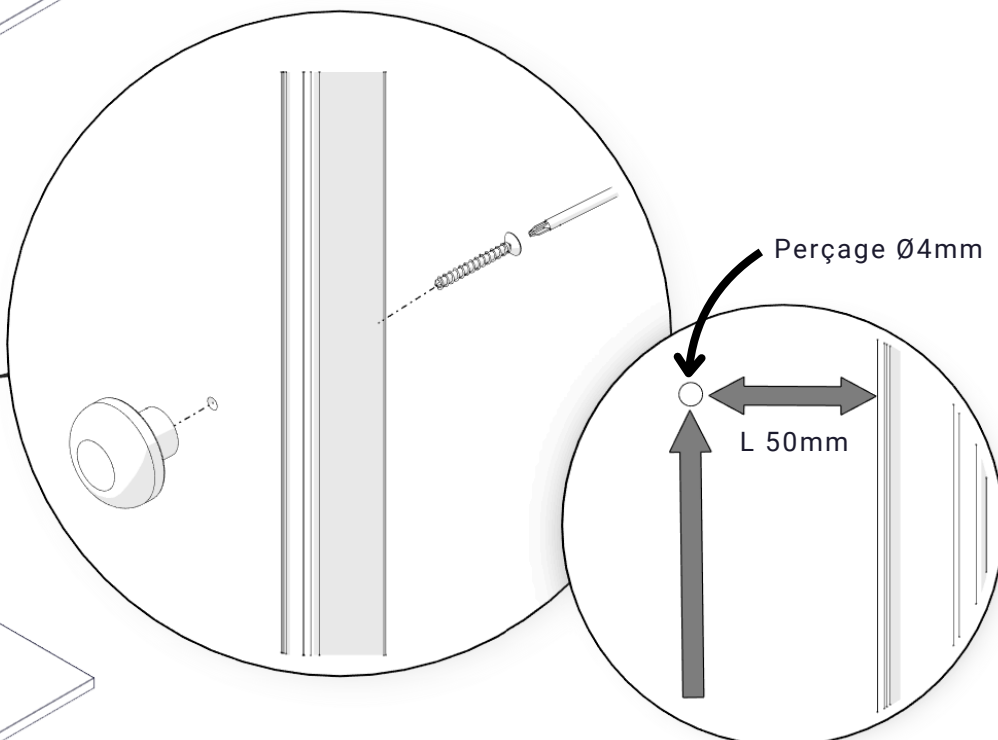
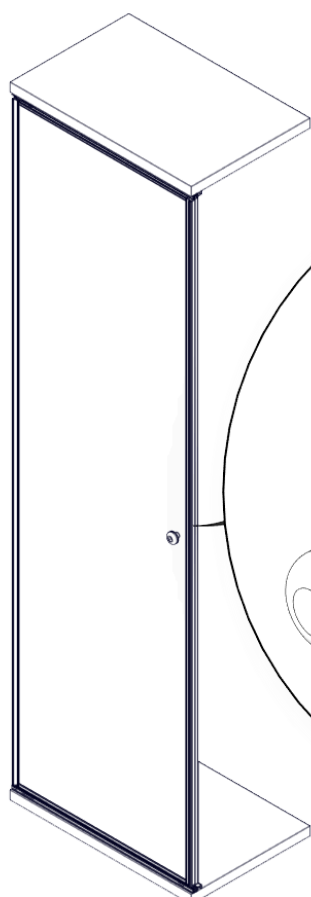

Hauteur conseillée :
1000mm

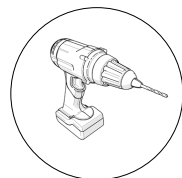

Perçage Ø4mm

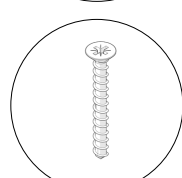
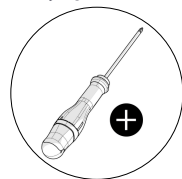

Vis 5x30

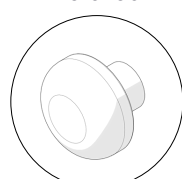

Bouton
plastique blanc