

# Caisson TOP ANGLE

(H1492,H1940,H2324)

## NOTICE DE MONTAGE

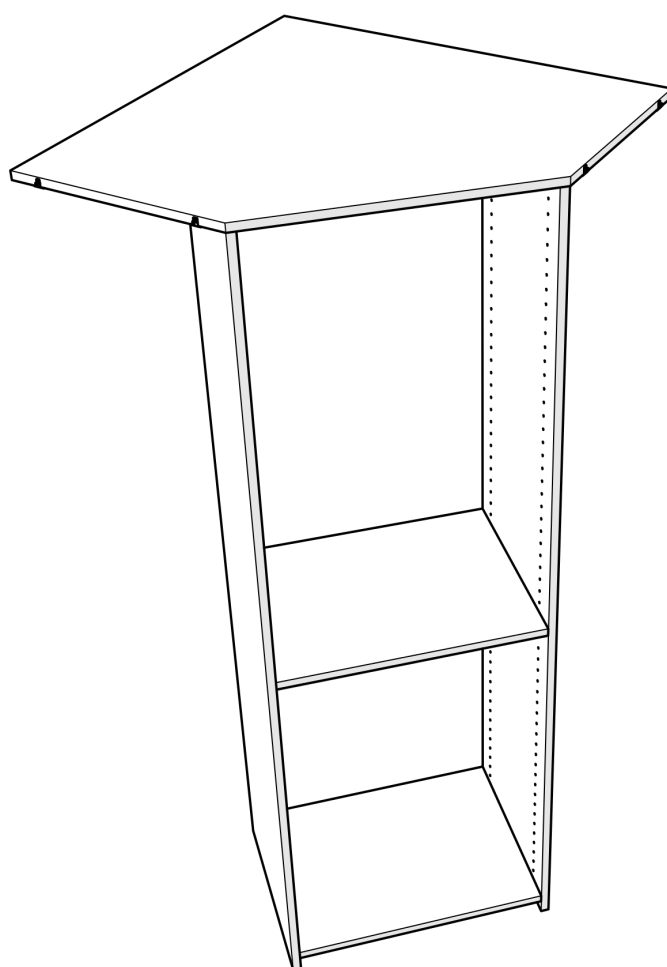

# INFORMATIONS

## Conseils d'entretien

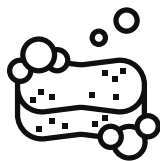

Nettoyer à  
l'eau tiède  
et au savon



Rincer à  
l'eau claire



Si besoin,  
utiliser du  
produit  
nettoyant pour  
vitres



Sécher avec  
un chiffon  
propre



**Ne pas  
utiliser de  
produits  
abrasifs**

CITEO | N° REGISTRE FR019580\_03UNYT



N° REGISTRE FR019580\_103YUI

ecomaison

N° REGISTRE FR019580\_04FIWL



FR  
Donnez ou recyclez  
vos meubles.



Association



Magasin



Déchèterie

<https://quefairedemesdechets.fr>



LE TRI  
+ FACILE



ecomaison



Membre de  
**l'Ameublement  
français**

## Fixations



**Aucune visserie n'est  
fournie pour la fixation au  
mur, au sol, ou au plafond.**  
Le choix de la fixation (vis +  
cheville) devra être adapté  
à votre support.

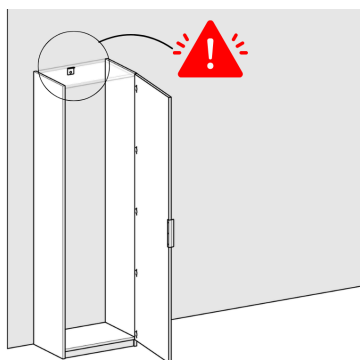
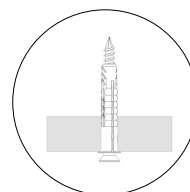
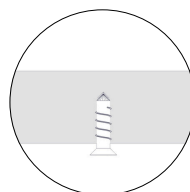
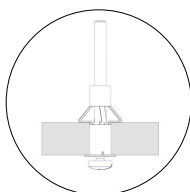

# INFORMATIONS

## Outils nécessaires

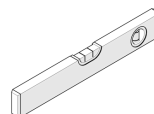
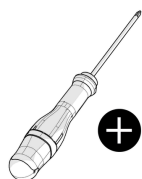

Mèche à bois Ø3

## Quincaillerie



Boitier  
excentrique x12



Cache D15 x12

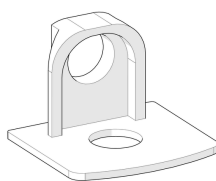

Support F18 X4



Goujon x12



Vis euro 4\*11 x4



Vis 3.5\*30x8

## Equipements



Tablettes mobiles



Tiroirs



Tablette à recouper



Tringle à recouper

# 1 Préparation des fixations sur les caissons attenants

**1.1** Percé les 2 trous des joues des composants latéraux avec une mèche de 3mm.

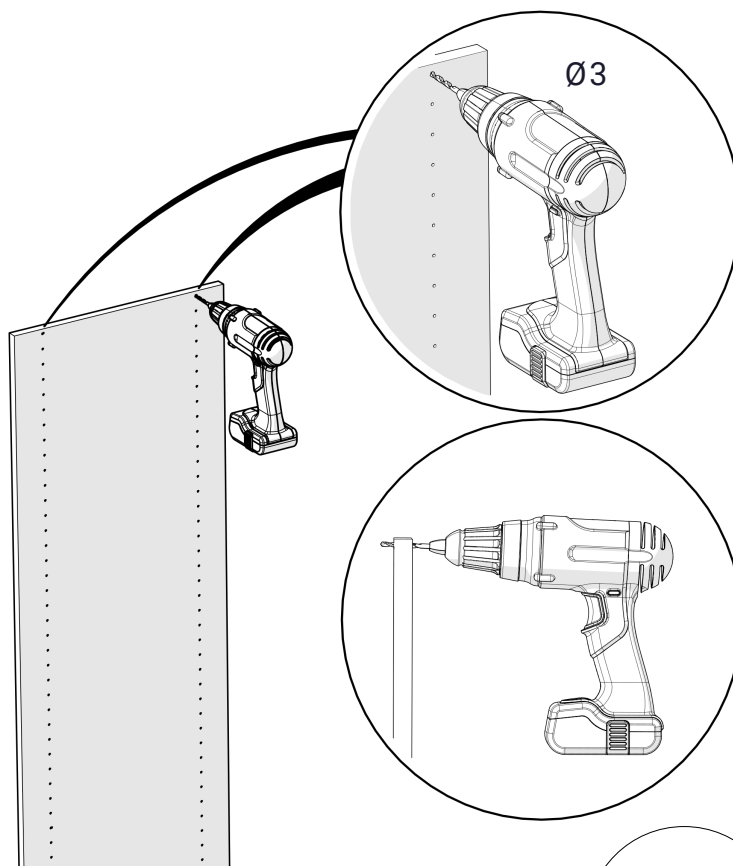
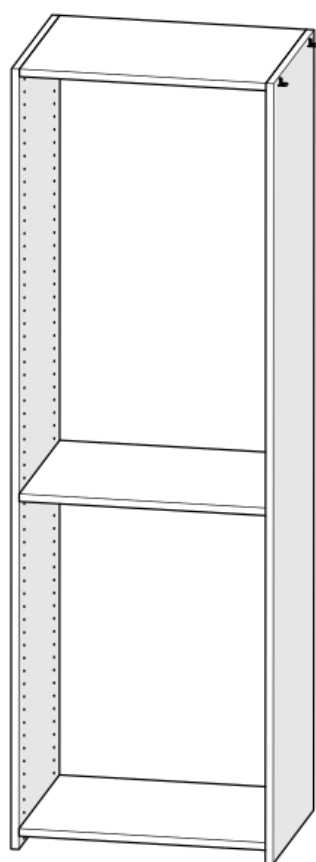
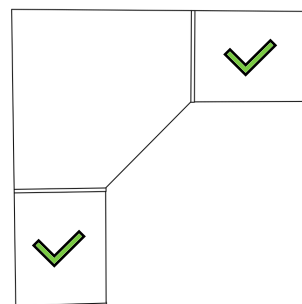

**1.2** Fixer les F18 à l'aide des vis fournis sur le côté extérieur des joues des composants latéraux.

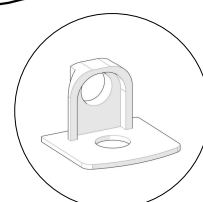
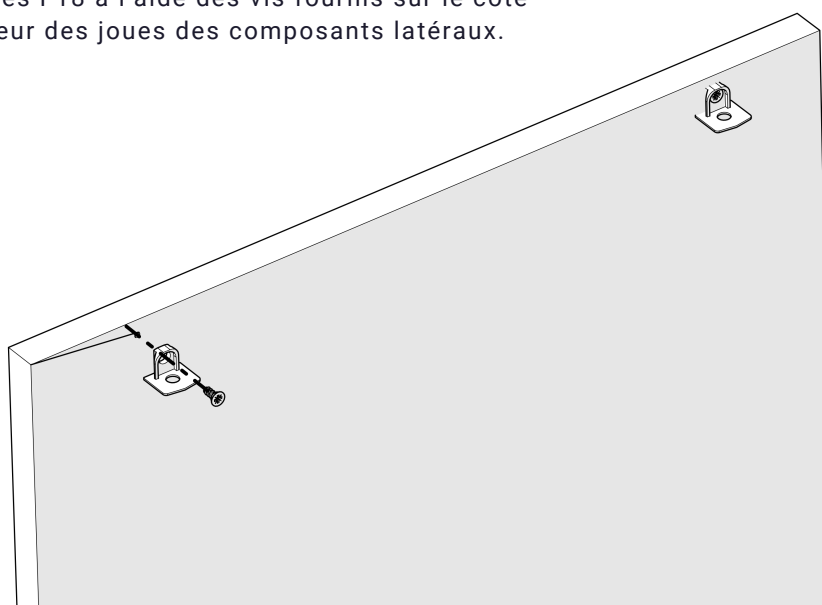

Support F18 X4

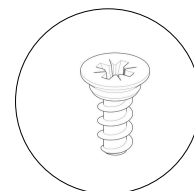

Vis euro 4\*11 x4

## 2 Préparation des quincailleries

### 2.1

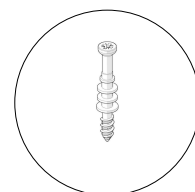
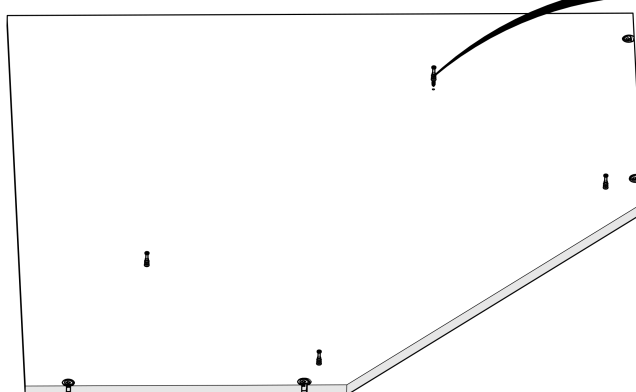
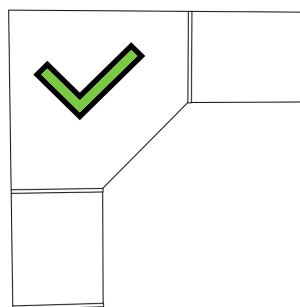
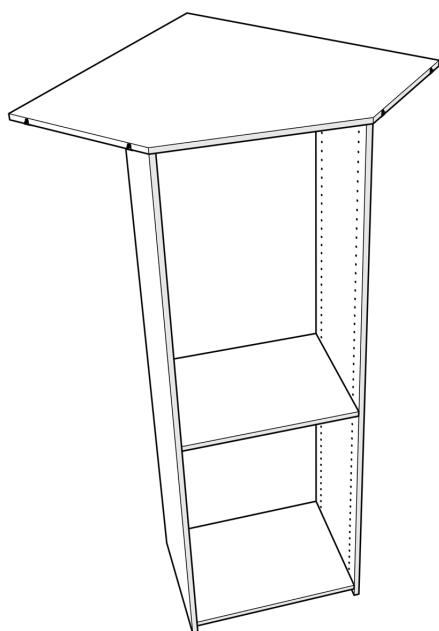

Goujon x4

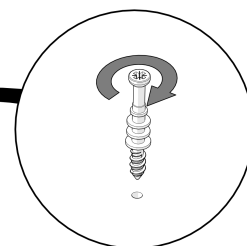

### 2.2

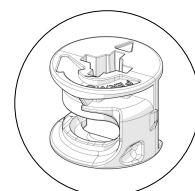
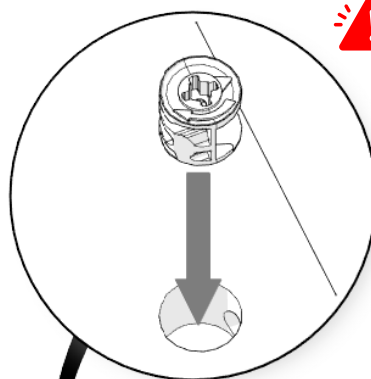
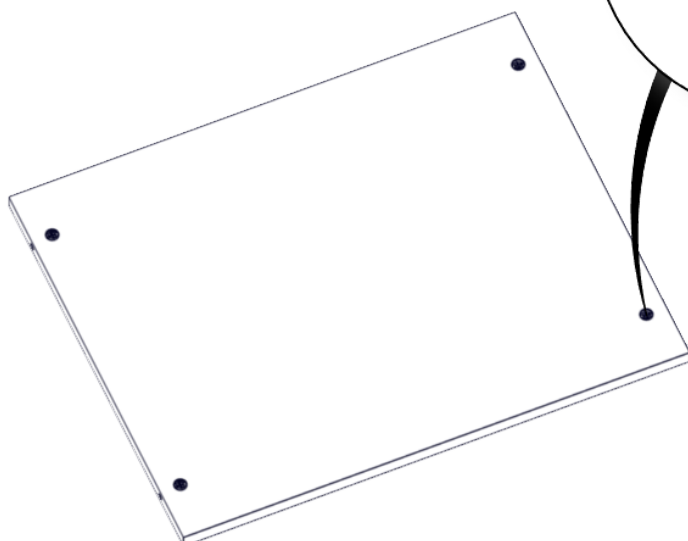

Boitier  
excentrique x8

## 2.3

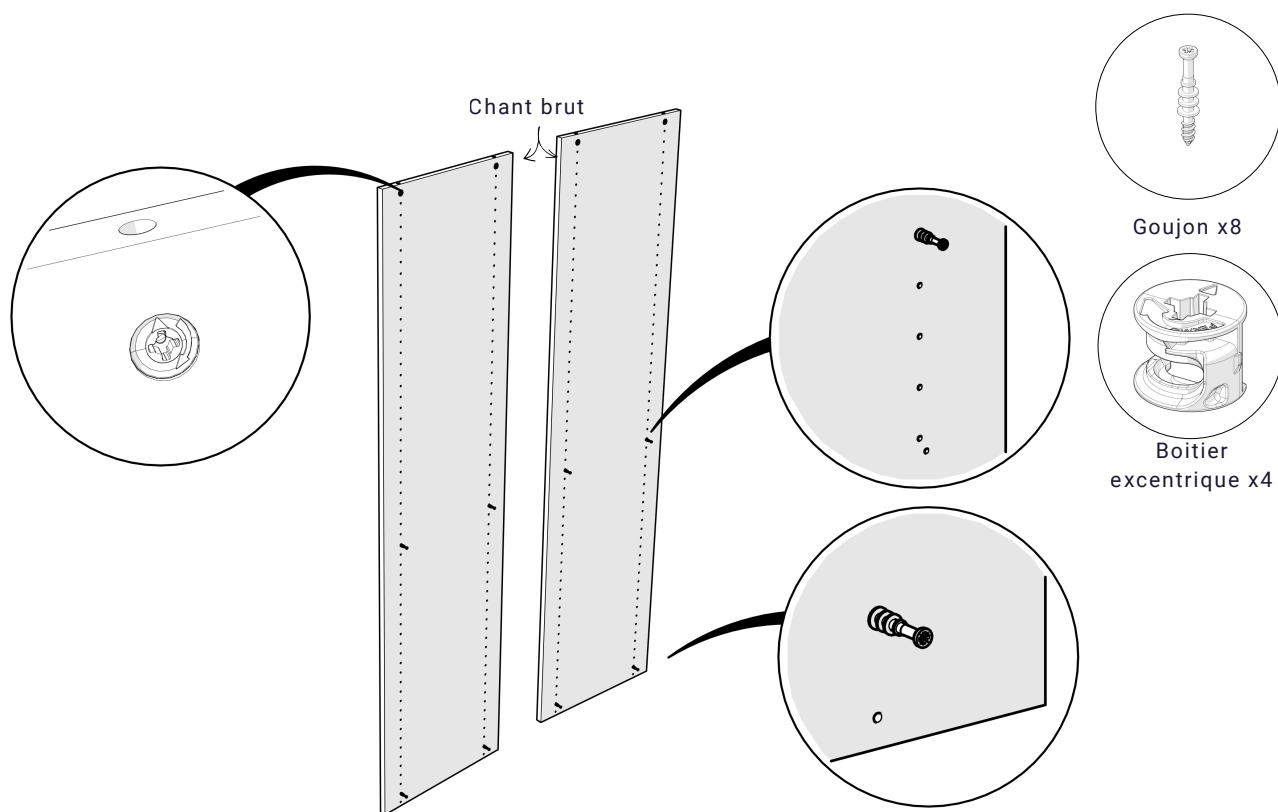

## 3 Assemblage joue gauche et tablettes

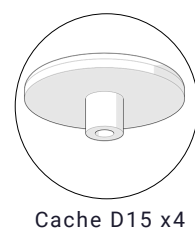

3.1

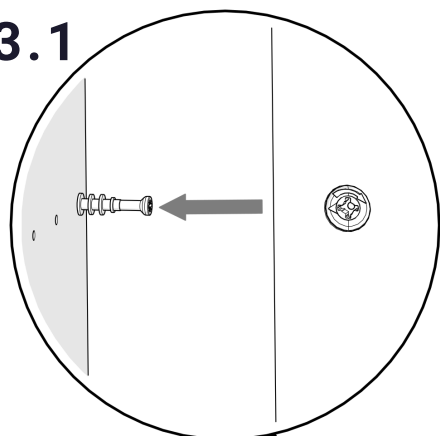

3.2

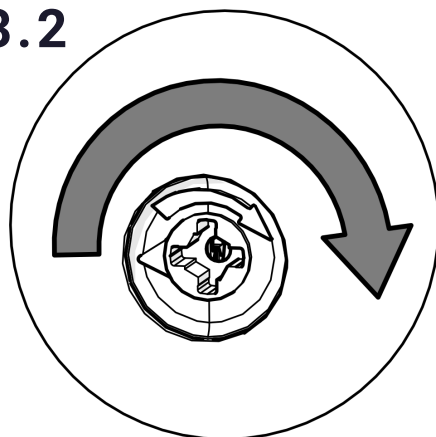

3.3

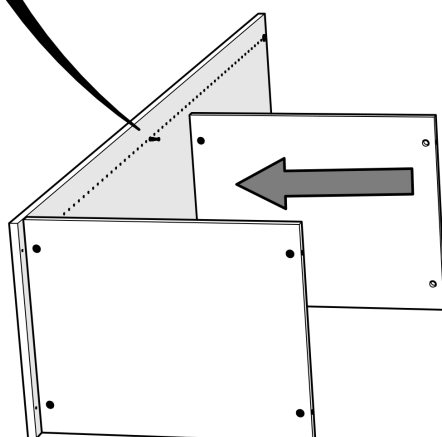
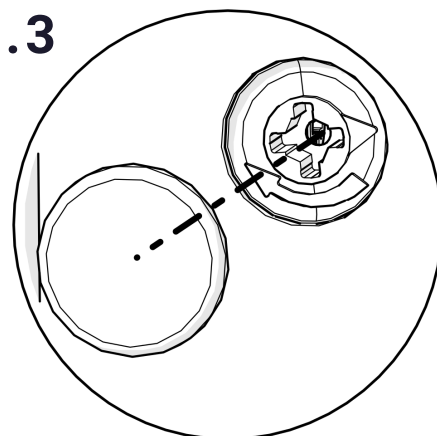

## 4 Assemblage joue droite

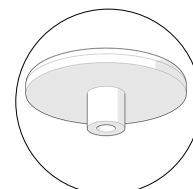

Cache D15 x4

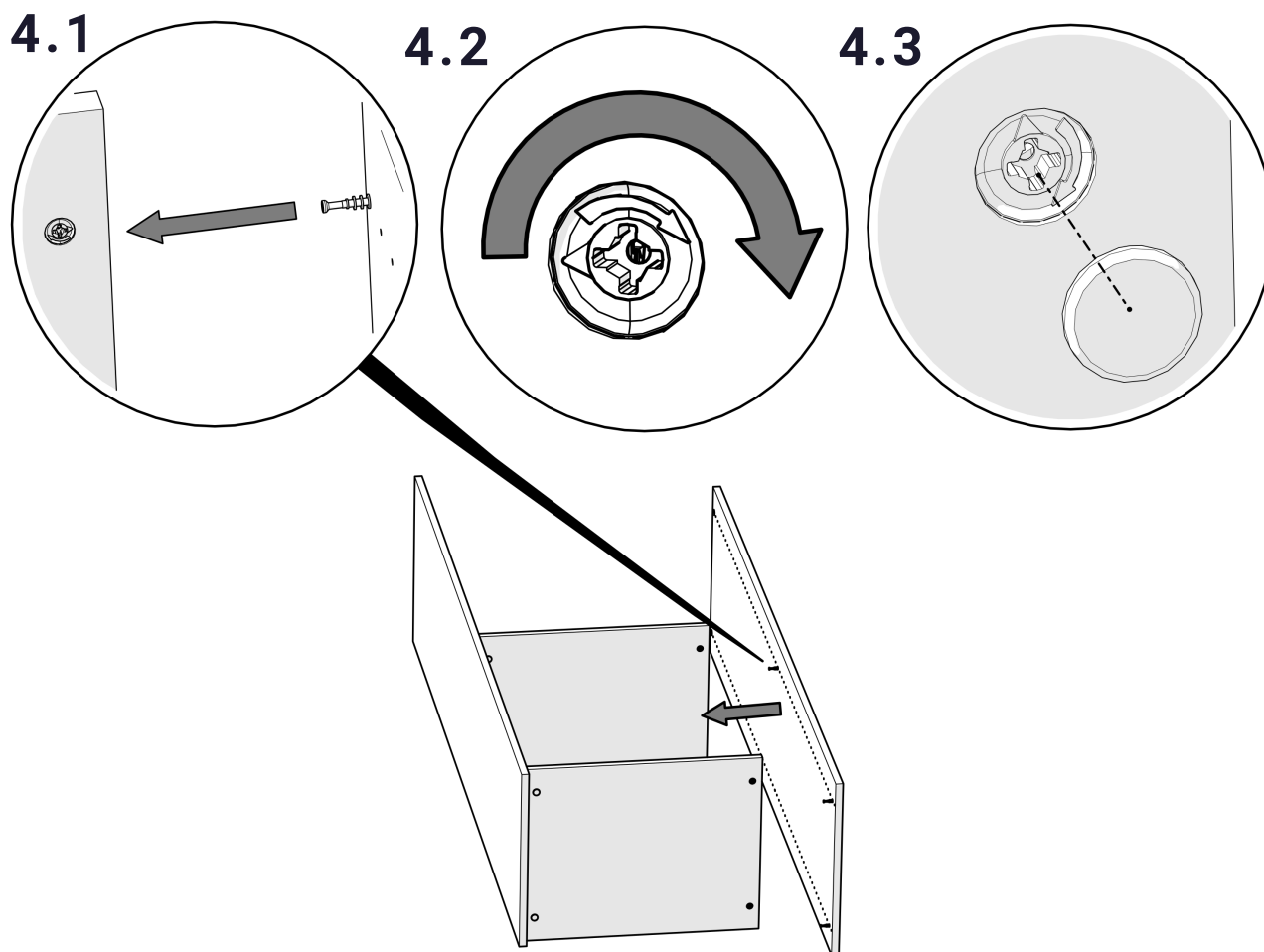

## 5 Redresser le caisson

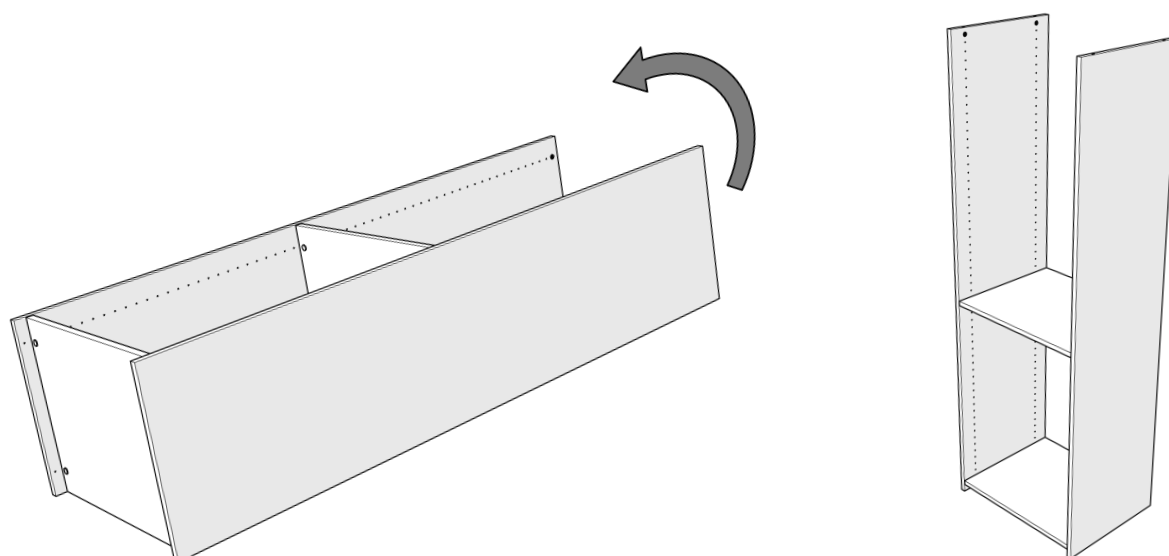

## 6 Mise en position du fond 10mm

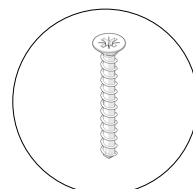
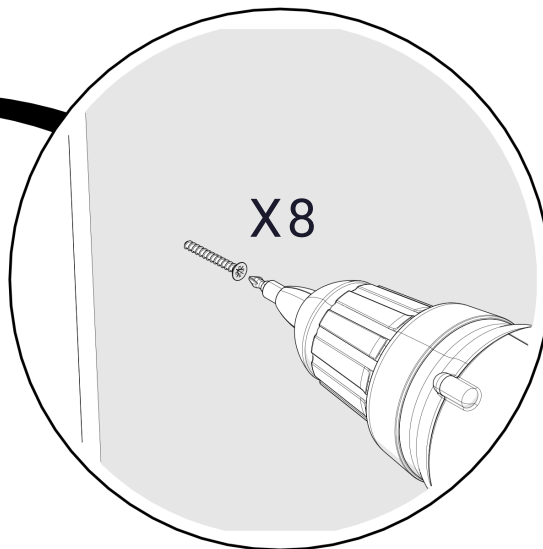
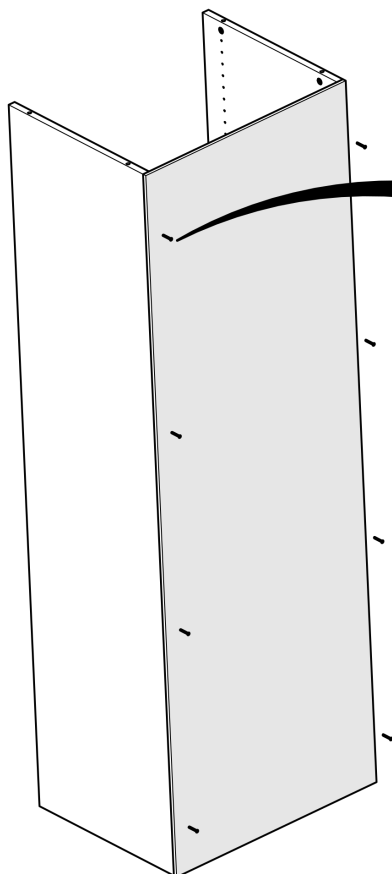

Vis 3.5\*30 x 8

## 7 Pose du TOP ANGLE

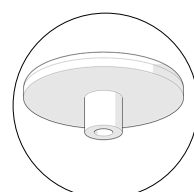

Cache D15 x4

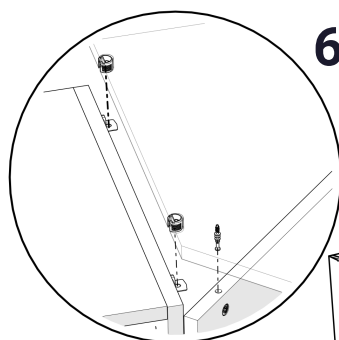

6.1

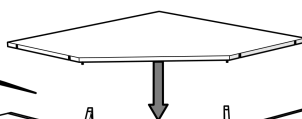

6.2

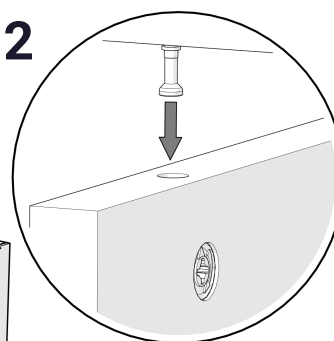

6.3

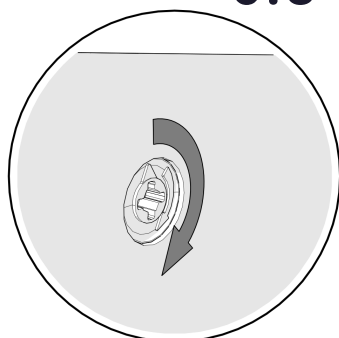

6.4

